

# Installation Instructions

## FULL WALL FACED TOILET SUITE

MILAN

UNIVERSAL INLET

### Installation of Toilet Seat and Cleaning

It is recommended that toilet seat and cover be installed after all trades are finished

#### Note:

Installation to be in accordance with AS/NZS 3500 series of Standards and/or local regulations.  
All measurements for roughing-in should be taken from finished wall/floor. It is strongly recommended by the manufacturer that installation is carried out by a licensed plumber.

### Cleaning Recommendations

The high quality vitreous china finish on all sanitary ware can be maintained by simply using mild soapy water and wiping over.

Sanitary ware should not be cleaned with abrasive materials e.g. steel wool/scourers. Do not use any corrosive or abrasive cleaning agents containing acids or scouring agents as this may lead to surface damage.

Bleaches can also discolour seats and hinges and therefore should not be used.

If your toilet has metal hinges they should only be cleaned with a mild liquid domestic cleaner, with soft soapsuds or Steel & Chrome cleaner

After cleaning, rinse with clean water and polish with a clean soft cloth.

### INSTALLATION INFORMATION

### S-Trap

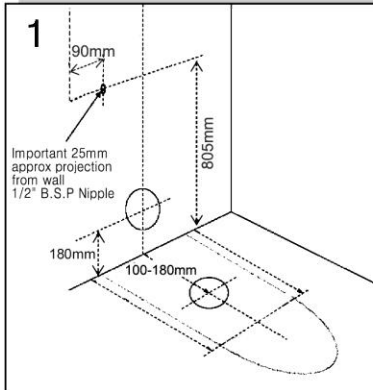

1. Rough in position of water inlet, waste outlet and floor fixing bracket holes. Ensure inlet connection extends 60mm from finished wall. Drill holes for floor fixing bracket then fix brackets to floor.

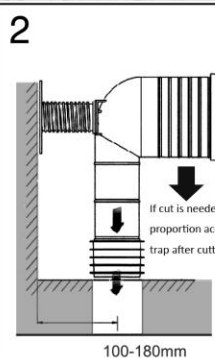

2. Lubricate the fins of the pan bend and position into waste pipe.

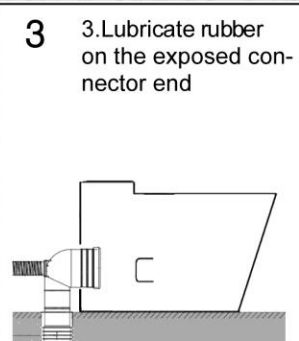

3. Lubricate rubber on the exposed connector end

### P Trap

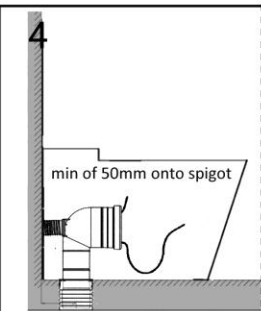

4. Align and push fully assembled toilet back to the wall

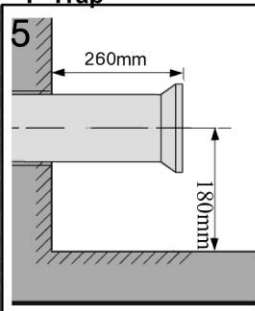

5. Set up waste pipe so that the end of the pan collar extends from the finished wall.

6. Align and push fully assembled toilet back to the wall, connecting pan spigot to pan collar. Bucket flush and check for leaks. Due to the design, weight, and stability of the pan and cistern a silicone adhesive only is recommended and excepted by manufacturer for floor based Fixing.

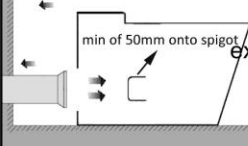

Before installing cistern, please check bungs and valves are tightened correctly. Put a bead of silicon to both upper and lower surfaces of foam rubber seal between cistern and pan. Place rubber seal at the bottom of the cistern, then gently lower cistern onto pan. Make sure the screws holes are matching between cistern and pan. Apply a bead of silicon around the bolts, then secure cistern to the pan. Before tightened fully make sure cistern sites square and straight to pan.

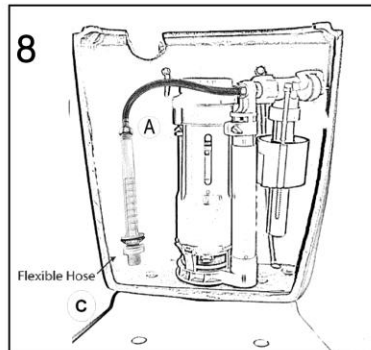

8. IF BACK INLET, SKIP THIS STEP. For Bottom (left hand) inlet connection, please connect flexible hose to plastic tube A, then complete stop tap connection to underside of cistern plug C. Fill cistern and ensure correct water level.

Note: Inlet valve can be adjusted if required.

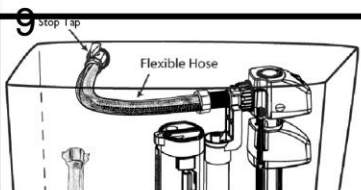

9. IF STEP 8 IS COMPLETED, SKIP THIS STEP. Fit off stop tap then connect rear water inlet valve to stop tap. Fill cistern and ensure correct water level.

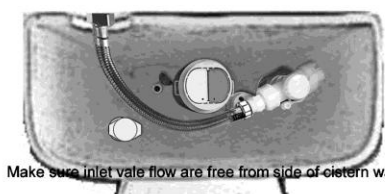

Make sure inlet valve flow are free from side of cistern wall.

If inlet valve been jam on the cistern wall, it will cause inlet vale keep filling.

## Toilet Cistern Installation Instruction

Please find the cistern bolts as the following, and separate it into 3 parts (A, B, C) as the picture:

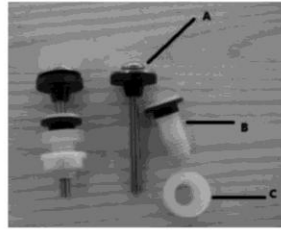

1. Insert the part B into the toilet pan holes. (as the photo)

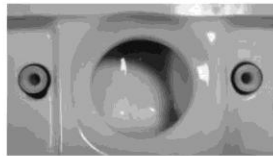

2. Use the part C including washer and tighten securely (under the pan) to the part B.



3. Put the cistern onto the pan and make sure it is in a right position, the bottom 2 holes are matching with the part B. Adjust the pan and cistern to line up if required.
4. Use a screw driver (or a drill at slow speed) to tighten the part A through the cistern into the part B. Please keep the cistern balanced during the process. Overtightening can cause crack in the tank. (**Note: watertight silicone can be used under part A to reduce possible leak if required.**)

## Toilet Seat installation Instruction

1. Please separate the black rubbers from the screw.
2. Insert the rubbers into the pan holes. Put the screw with the white bracket on the pan and screw into the rubber( do not tighten).
3. Push the seat(press and hold the chrome button inside the seat) onto the metal pin(on the white bracket), and adjust the pin position to make sure the seat is in a right position. Then take off the seat and tighten the screws to secure the brackets.
4. Put the metal cover onto the brackets, and the seat.

